



Mail to:

CA of Wisconsin

PO Box 340653

Milwaukee, WI 53234

If you have any questions, please contact

Matt M. 262-232-2321 Chair

Cass C. 414-708-5906 Co-Chair

Many people arrive early on Friday to enjoy fellowship while hiking and fishing in a beautiful natural setting.

## What to bring

Bedding; pillow, blanket, and sheets or sleeping bag

Towel / Personal hygiene items

Recovery reading material

Bring snacks, soda – water, coffee, tea, and hot chocolate are provided.

You might want to bring a small flashlight and a lawn chair for your comfort

Optional: A dish to pass for Friday night dinner and extra cash for free time activities

And

***A WILLINGNESS TO GROW***

## What NOT to bring

No TV

No Radios

No music players

Remember this is a spiritual, relaxing and meditative retreat!

***No pets of any kind allowed***

In the spirit of our sixth tradition C.A. is not allied with any sect, denomination, politics, organization, or institution.

---

# Spring Retreat 2025

---

March 28<sup>th</sup> -30<sup>th</sup>

**Principles**

**Before**

**Personalities**



Timber-lee

N8705 Scout Rd

East Troy, WI 53120

***This is a closed CA event. For recovering Addicts/Alcoholics only***

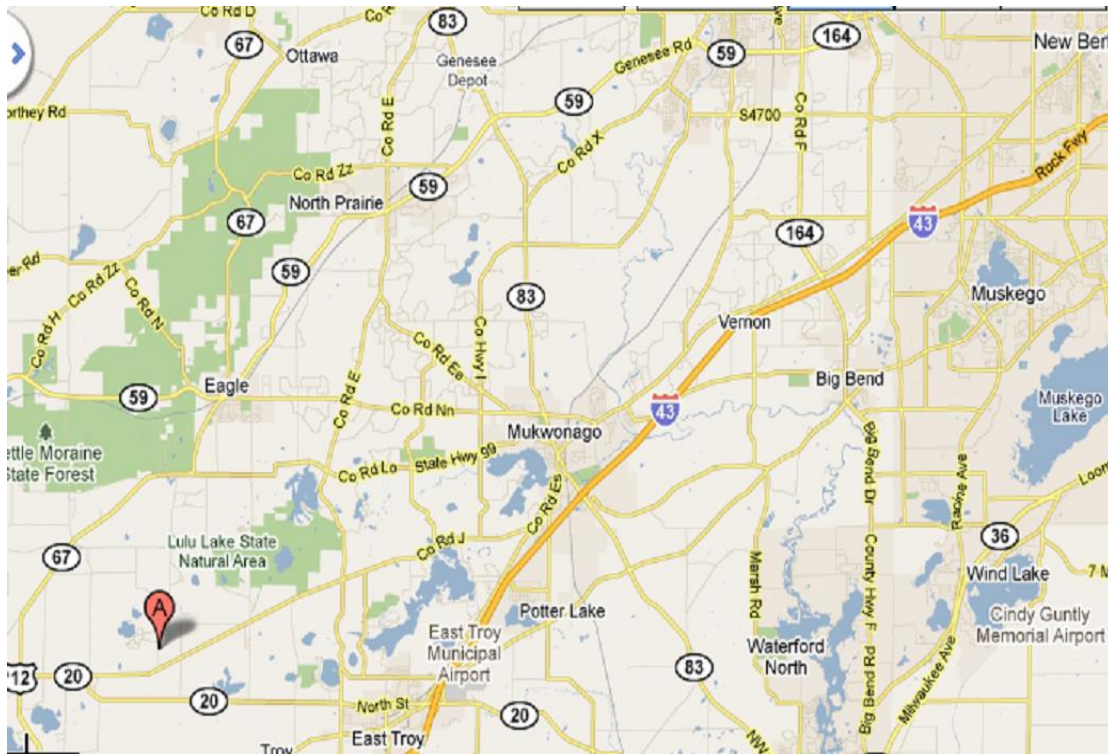
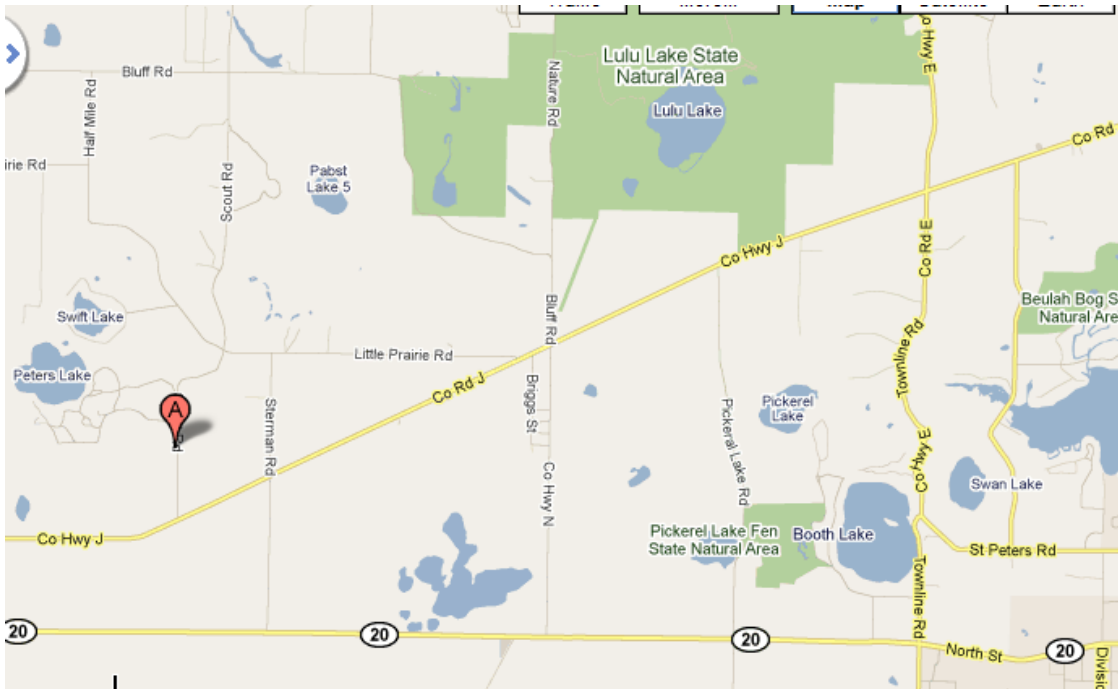

## Spring Retreat

Full payment before 3/14/2025

120.00

Full payment after 3/14/2025

130.00

Balance Due March 21<sup>ST</sup>

Registration is time sensitive.

Name \_\_\_\_\_

Address \_\_\_\_\_

Phone \_\_\_\_\_

Email \_\_\_\_\_

Method of payment

\_\_\_ Check

\_\_\_ Cash

Amount Paid

\_\_\_ \$20 down

\_\_\_ Paid in full

Mail to:

CA of Wisconsin

PO Box 340653

Milwaukee, WI 53234